



# 2.6 Rückwandhalter

Klappenhalter, Schnäpper, Schrankrohlager





# Klappenhalter, gebremst

## brake-type drop lid holder

Ausfuhung  
type

**Bremsklappenhalter komplett,  
bestehend aus:**

Gehause, Schiene und Futeil,  
mit Feststellschraube

**brake-type drop lid holder complete,  
consisting of:**

housing, guide rail and foot part,  
with adjusting screw

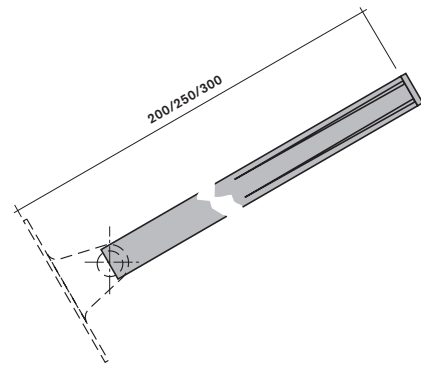
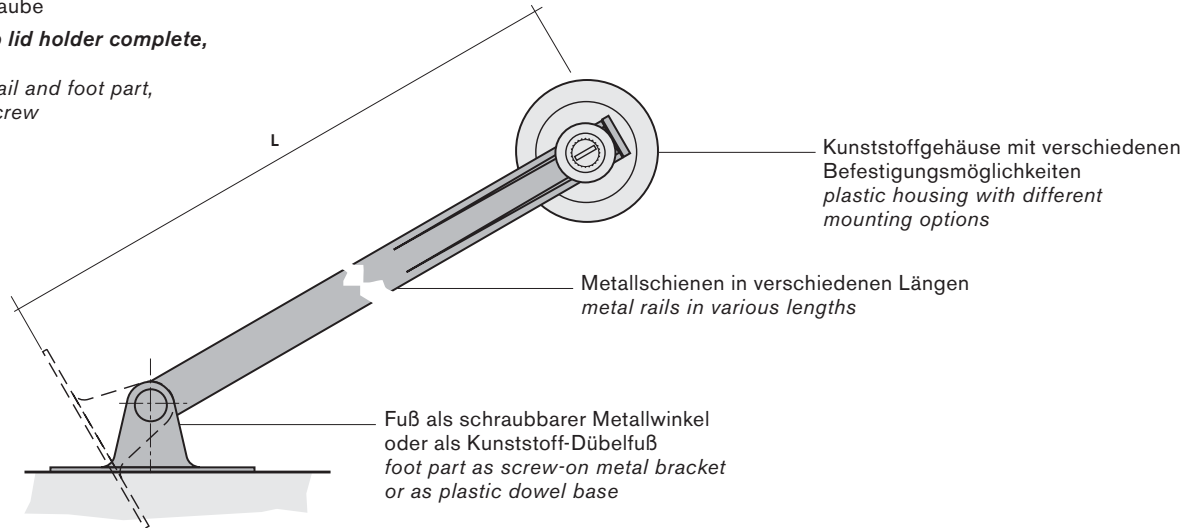

**Gehause mit 2 x Dubel  
und 1 x Schraubloch**  
housing with 2 x dowel  
and 1 x screw-hole

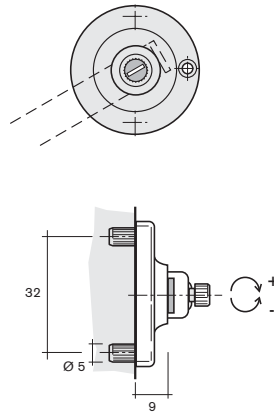

**Gehause mit  
3 x Schraubloch**  
housing with  
3 x screw-hole

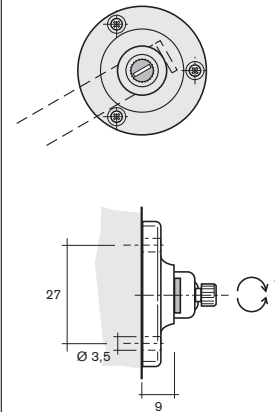

**Gehause mit 2 x Spreiz-  
dubel und 1 x Schraubloch**  
housing with 2 x expanding  
dowel and 1 x screw-hole

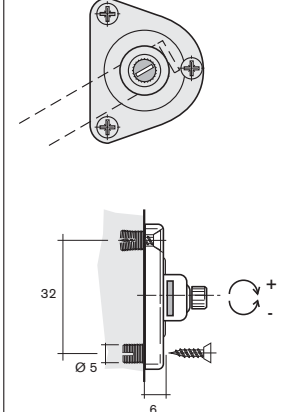

**Winkel schraubbar**  
bracket screwed on

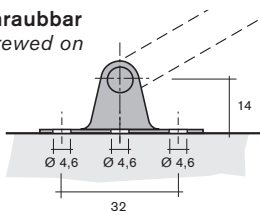

**Dubelfu**  
dowel base

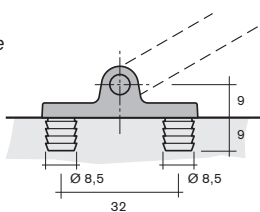

L 200	n.a.	L 200	10.9750	L 200	10.9670
L 250	10.9730	L 250	10.9740	L 250	10.9780
L 300	n.a.	L 300	10.9760	L 300	10.9660
L 200	10.9770	L 200	n.a.	L 200	n.a.
L 250	10.9710	L 250	10.9650	L 250	10.9700
L 300	n.a.	L 300	n.a.	L 300	n.a.

# Klappenhalter

drop lid holder

Art.-Nr.      Verp. Einheit      Ausfuhrung      Farben: wei, braun  
art.-no.      packing units      type      colours: white, brown

60.0710

1.000

**total Kunststoff, 3-teilig**  
beidseitig gedubelt  
**total plastic, 3-parts**  
2-times dowelled

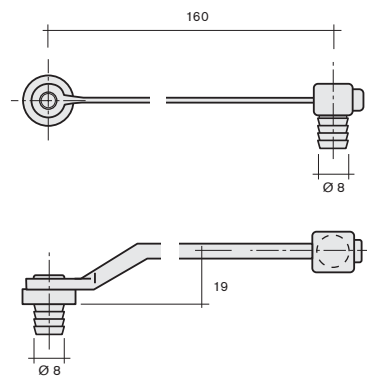
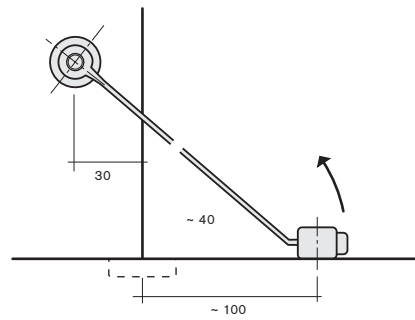

# Schuhschrank-Klappenbeschlag

## shoe cabinet flap fitting

Art.-Nr. Verp. Einheit Ausfuhrung Farben: wei, braun  
 art.-no. packing units type colours: white, brown

- 60.2550
- 60.2560
- 60.2880
- 60.2900
- 60.2890

**Klappenlager-Sets komplett, bestehend aus:**

2 x Seitenteile, rechts + links  
 2 x Drehlager  
 2 x Anschlage  
**flap bearing sets complete, consisting of:**  
 2 x side parts, right + left  
 2 x rotary bearing  
 2 x stops

**Seitenteile-Set klein**

mit 2 Fachern  
**side parts set small**  
 with 2 compartments

**Seitenteile-Set gro**

mit 3 Fachern  
**side parts set large**  
 with 3 compartments

**Lagerbuchse**

**bearing socket**

**Harpunenbuchse**

**harpoon socket**

**Anschlag**

**stop**

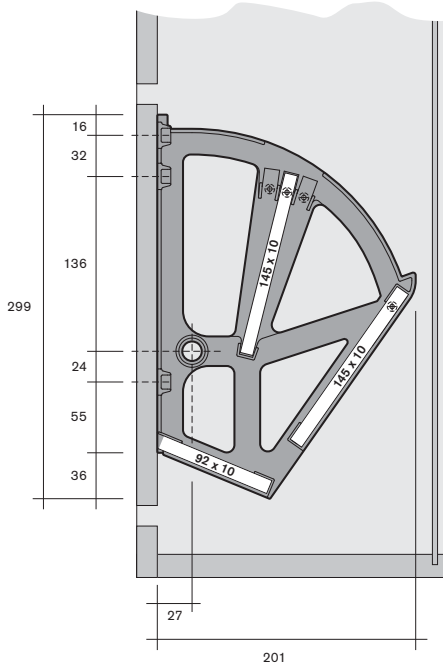
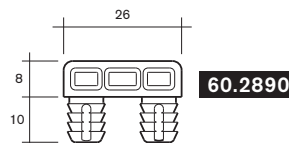
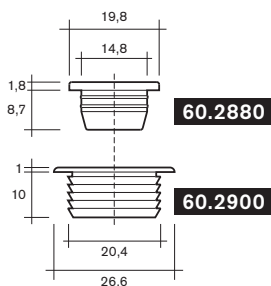
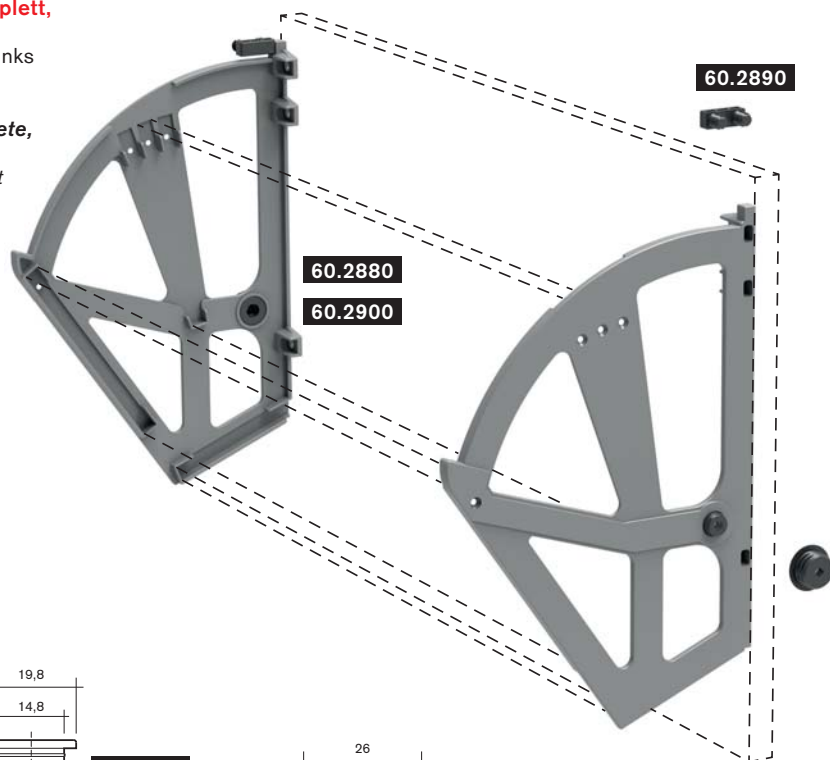

**60.2550**

Seitenteile 2 Facher  
 side parts 2 compartments

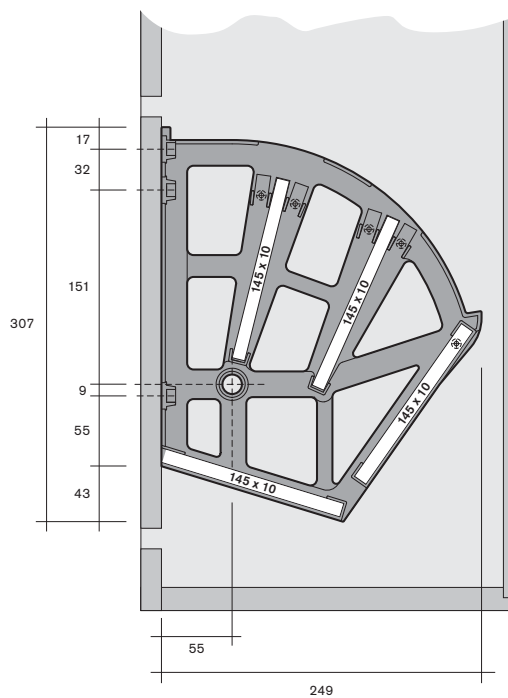

**60.2560**

Seitenteile 3 Facher  
 side parts 3 compartments

# Magnetschnäpper

## magnetic catches

Art.-Nr.      Verp. Einheit      Ausführung      Farben: weiß, braun  
 art.-no.      packing units      type      colours: white, brown

**10.1640**      **1.000**      **Einfachmagnet**  
 Haltekraft 3–4 kg  
*simple magnetic catch*  
 adhesive power 3–4 kg

**10.1650**      **1.000**      **Einfachmagnet**  
 Haltekraft 4–5 kg  
*simple magnetic catch*  
 adhesive power 4–5 kg

**37.0650**      **100**      **Einfachmagnet**  
 Haltekraft 6 kg  
*simple magnetic catch*  
 adhesive power 6 kg

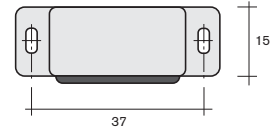
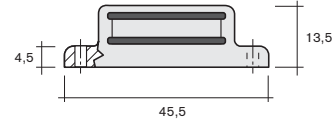

**10.1640**

**10.1660**      **50**      **Doppelmagnet**  
 Haltekraft 3–4 kg  
*double magnetic catch*  
 adhesive power 3–4 kg

**10.1670**      **50**      **Doppelmagnet**  
 Haltekraft 4–5 kg  
*double magnetic catch*  
 adhesive power 4–5 kg

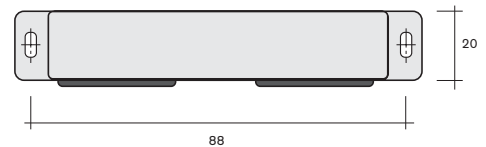
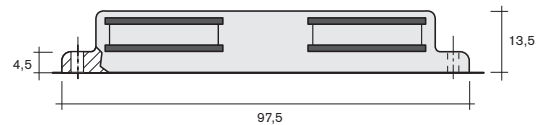

**10.1660**

**10.0800**      **1.000**      **Gegenplatte**  
 1 Schraubloch  
*strike plate*  
 1 screw-hole

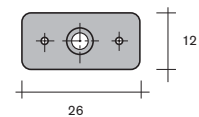

# Magnetschnäpper

## magnetic catches

Art.-Nr.    Verp. Einheit    Ausfuhrung    Farben: wei, braun  
 art.-no.    packing units    type    colours: white, brown

10.0860

500

**Gegenplatte**  
 abgerundet, 1 Schraubloch  
**strike plate**  
 rounded, 1 screw hole

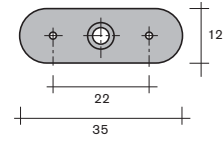

10.0820

500

**Gegenplatte, beweglich**  
 2 Langlocher, Teilung 36,5 mm  
 justierbar  
**strike plate, self-adjusting**  
 2 oblong holes, 36,5 mm spacing  
 adjustable

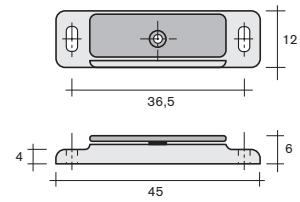

10.0850

1.000

**Gegenplatte, rund**  
 ø 14,2 mm  
**strike plate, round**  
 ø 14.2 mm

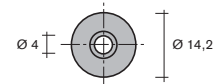

# Rollenschnäpper

## roller catches

Art.-Nr.      Verp. Einheit      Ausfuhrung      Farben: wei, braun  
 art.-no.      packing units      type      colours: white, brown

**38.0400**

**500**

**schraubbar, justierbar**  
*screwable, adjustable*

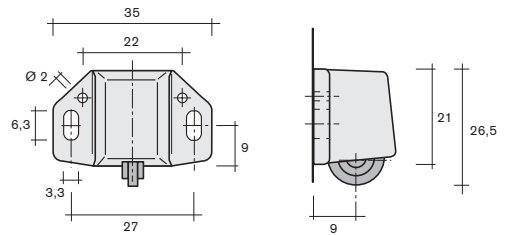

**38.0410**

**500**

**zweifach gedubelt**  
 Teilung 32 mm  
**dowelled twice**  
 32 mm spacing

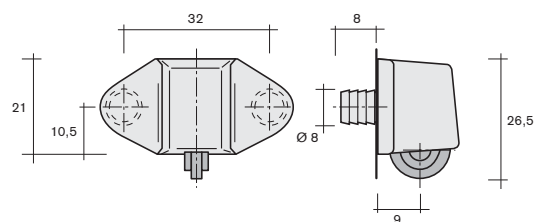

**38.0420**

**500**

**Anschlag fur Schnapper**  
 schraubbar, justierbar  
**stop for roller catch**  
*screwable, adjustable*

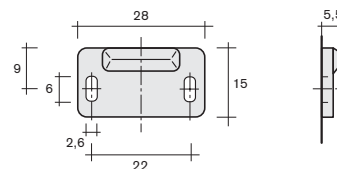

**38.0480**

**1.000**

**Anschlag fur Schnapper**  
 schraubbar, justierbar  
**stop for roller catch**  
*screwable, adjustable*

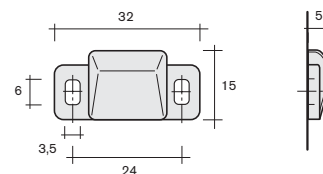

**38.0430**

**1.000**

**Anschlag fur Schnapper**  
 dubelbar  
**stop for roller catch**  
*dowelable*

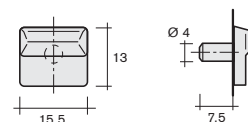



# Rückwandhalter

## rear panel supports

Art.-Nr. Verp. Einheit Ausfuhrung Farben: wei, braun, beige  
 art.-no. packing units type colours: white, brown, beige

**gedubelt, seitlich verschraubt**  
*dowelled, screwed on at side*

		Dubelabstand dowel spacing	Bohrungsabstand hole spacing
<b>57.0660</b>	<b>2.500</b>	10 mm	16 mm
<b>57.0500</b>	<b>7.500</b>	15 mm	15 mm
<b>57.0520</b>	<b>7.000</b>	15 mm	20 mm
<b>57.0550</b>	<b>5.000</b>	15 mm	25 mm
<b>57.0490</b>	<b>4.500</b>	15 mm	29 mm
<b>57.0560</b>	<b>6.000</b>	15 mm	31,5 mm
<b>57.0600</b>	<b>4.500</b>	15 mm	32 mm
<b>57.0570</b>	<b>4.500</b>	15 mm	37 mm

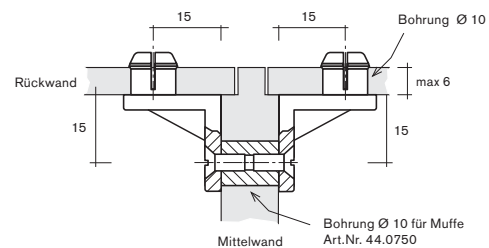
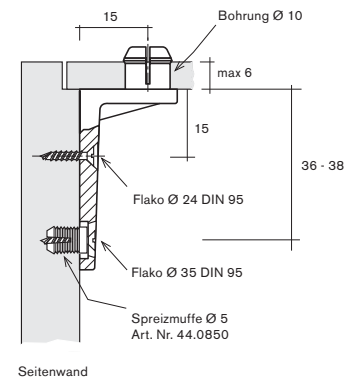
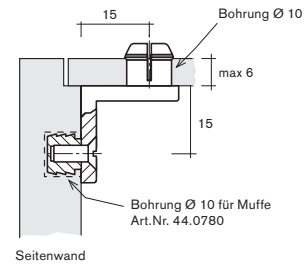
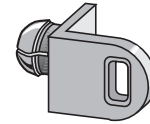

# Rückwandhalter

## rear panel supports

Art.-Nr.      Verp. Einheit      Ausfuhrung      Farben: wei, braun, beige  
 art.-no.      packing units      type      colours: white, brown, beige

**gehakt, mit Nase, seitlich verschraubt**  
*hooked, with nose, screwed on at side*

		A	B
<b>57.0510</b>	<b>7.500</b>	groe Senkung/ <i>large countersunk</i> 15 mm	15 mm
<b>57.0580</b>	<b>8.000</b>	kleine Senkung/ <i>small countersunk</i> 15 mm	15 mm
<b>57.0630</b>	<b>7.500</b>	fur Euroschraubel/ <i>for euro screw</i> 15 mm	15 mm
<b>57.1040</b>	<b>6.000</b>	fur Euroschraubel/ <i>for euro screw</i> 15 mm	20 mm
<b>57.0690</b>	<b>5.500</b>	fur Euroschraubel/ <i>for euro screw*</i> 15 mm	28 mm
<b>57.0620</b>	<b>5.500</b>	groe Senkung/ <i>large countersunk</i> 15 mm	30 mm
<b>57.0740</b>	<b>5.500</b>	fur Euroschraubel/ <i>for euro screw*</i> 15 mm	32 mm
<b>57.1000</b>	<b>4.500</b>	Senkloch quer/ <i>countersunk-hole across*</i> 15 mm	36 mm
<b>57.0710</b>	<b>6.000</b>	groe Senkung/ <i>large countersunk</i> 21 mm	22,5 mm
<b>57.0590</b>	<b>1.500</b>	groe Senkung/ <i>large countersunk</i> 21 mm	32 mm
<b>57.0480</b>	<b>3.500</b>	135° Winkel fur 2x Euroschraube/ <i>135° angle for 2x euro screw</i>	
<b>57.1090</b>	<b>4.000</b>	groe Senkung/ <i>large countersunk</i> 21 mm	12 mm
<b>57.1080</b>	<b>3.200</b>	fur 2x Euroschraubel/ <i>for 2x euro screw</i> 15 mm	22,5/48 mm

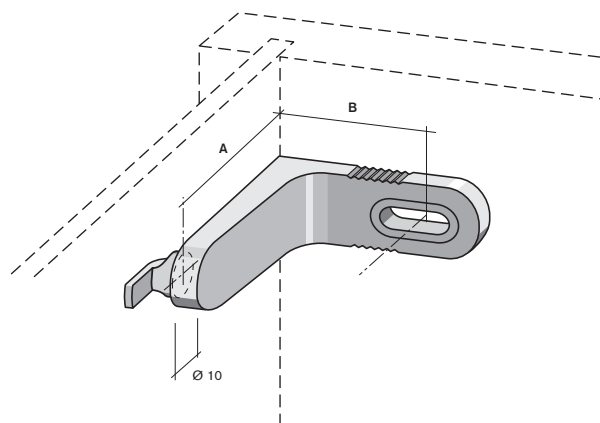

\* zusatzliche Befestigungsbohrung Senkung  
*additional fastening hole countersunk*

# Rückwandhalter/-verbinder

rear panel supports/-connectors

Art.-Nr.    Verp. Einheit    Ausfuhrung    Farben: wei, braun, beige  
art.-no.    packing units    type    colours: white, brown, beige

60.6160

2.000

**Verbindungslasche**  
100 x 28 x 2,5 mm  
**connecting strap**  
100 x 28 x 2.5 mm

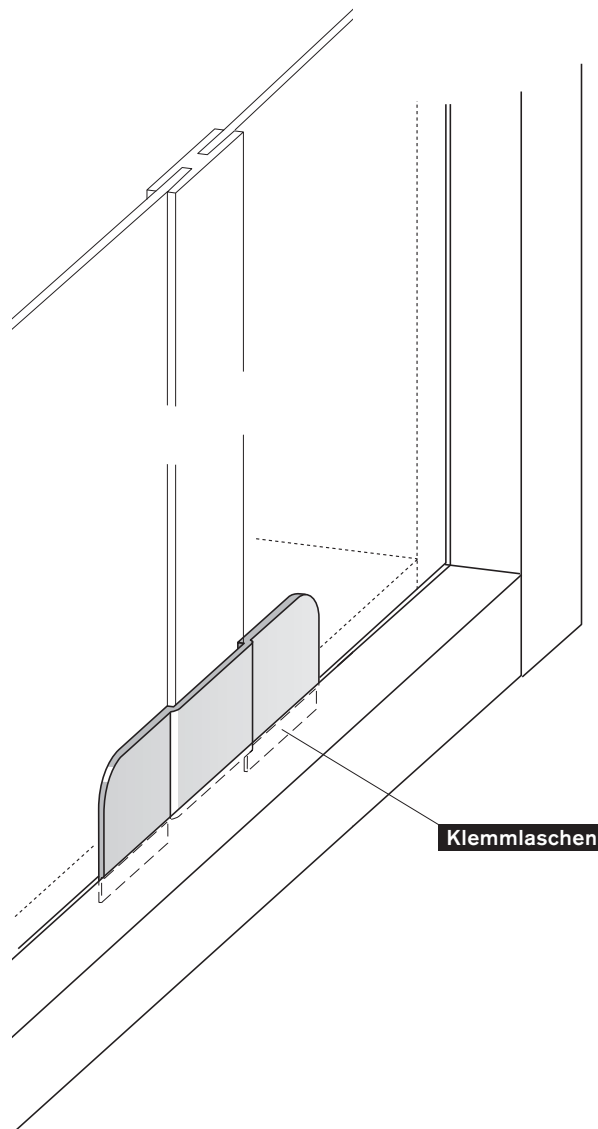
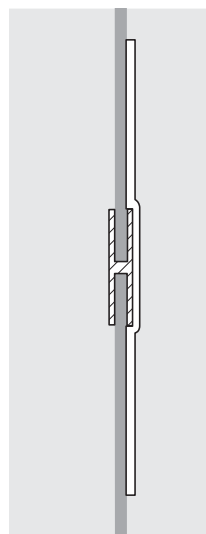
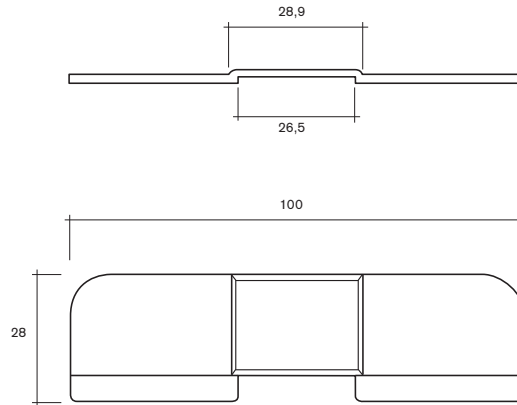

# Metall-Rückwandhalter Ausführung: vernickelt

## metal rear panel supports finish: nickel-plated

 **Henke Beschlage**

Art.-Nr.      Verp. Einheit      Ausfuhrung  
 art.-no.      packing units      type

**99.5000**

**650**

**gehakt, zweifach seitlich schraubbar**  
 Euro- und Senkkopfschraube  
**hooked, screwable on twice at side**  
 Euro- and countersunk screw

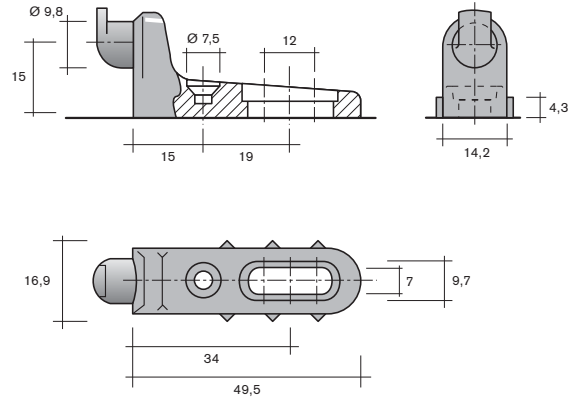

**99.5010**

**650**

**gehakt, seitlich geschraubt**  
 Langlochgroe: 4,1 x 16,1 mm  
 fur Senkschrauben, Unterseite ausgespart  
 fur Muffen mit Band Art.-Nr. 44.0860, vernickelt  
**hooked screwed on at side**  
 oblong hole size: 4.1 x 16.1 mm  
 for countersunk screws, underside recessed for  
 straddling dowel with collar Art.-No. 44.0860,  
 nickel-plated

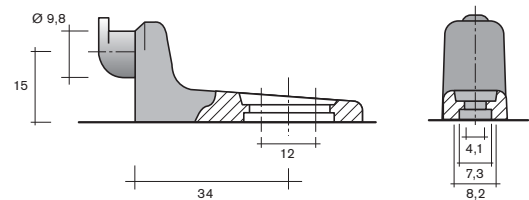

**99.5020**

**650**

**gehakt, seitlich geschraubt**  
 Langlochgroe: 4,1 x 16,1 mm  
 fur Flachkopfschrauben, Unterseite ausgespart,  
 fur Muffen mit Band Art.-Nr. 44.0860, vernickelt  
**hooked screwed on at side**  
 oblong hole size: 4.1 x 16.1 mm  
 for pan head screws, underside recessed for  
 straddling dowel with collar Art.-No. 44.0860,  
 nickel-plated

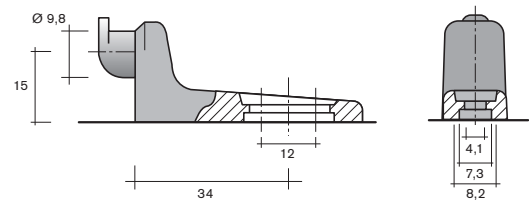

**99.5020**

**99.5030**

**1.300**

**gehakt, seitlich geschraubt**  
 passend fur Euro-Schraube und Senkkopfschraube  
**hooked screwed on at side**  
 suitable for Euro screw and countersunk screw

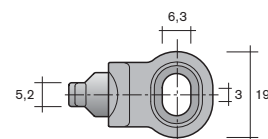
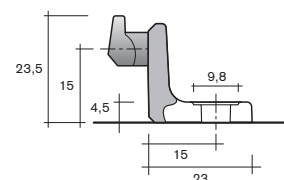

# Metall-Rückwandhalter Ausführung: vernickelt

## metal rear panel supports finish: nickel-plated



Art.-Nr.    Verp. Einheit    Ausführung  
 art.-no.    packing units    type

99.6030

600

**gehakt, zweifach seitlich schraubbar**  
 2 Langlöcher für Euro-Schraube,  
 32 mm Bohrraster  
**hooked screwed on twice at side**  
 2 oblong holes for Euro screw, 32 mm spacing

X = 90° Winkel  
 X = 90° angle

99.5040

600

X = 135° Winkel  
 X = 135° angle

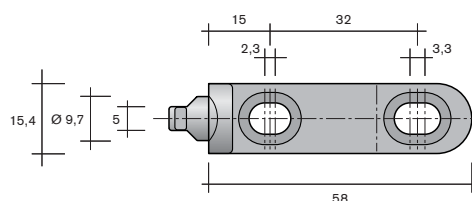
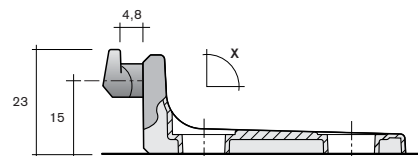

99.5070

1.300

**gehakt, zweifach seitlich schraubbar**  
 Euro- und Senkkopfschraube  
**hooked, screwable on twice at side**  
 Euro- and countersunk screw

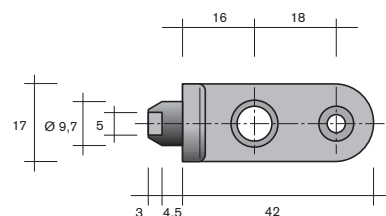
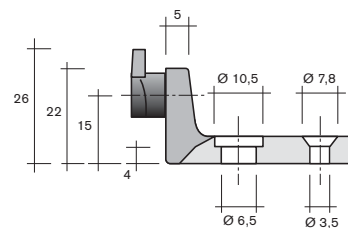

99.6300

1.300

**gehakt, zweifach seitlich schraubbar**  
 Euro- und Senkkopfschraube  
**hooked, screwable on twice at side**  
 Euro- and countersunk screw

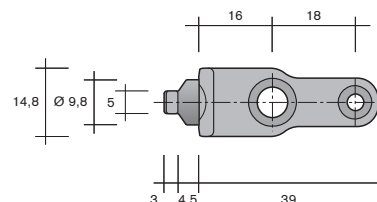
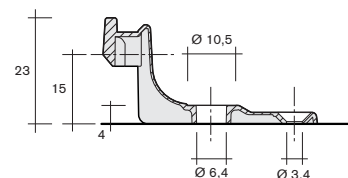

# Metall-Rückwandhalter Ausführung: vernickelt

## metal rear panel supports finish: nickel-plated

 **Henke Beschlage**

Art.-Nr.      Verp. Einheit      Ausfuhung  
art.-no.      packing units      type

**99.6600**

**1.200**

**gehakt, zweifach seitlich schraubbar**  
Euro- und Senkkopfschraube  
**hooked, screwable on twice at side**  
Euro- and countersunk screw

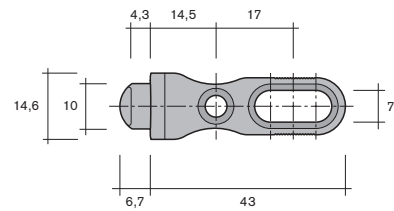
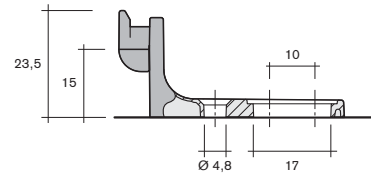

**99.6610**

**650**

**gehakt, 1 x 90° und 1 x 45° schraubbar**  
Euro- und Senkkopfschraube  
**hooked, 1 x 90° and 1 x 45° screwable**  
Euro- and countersunk screw

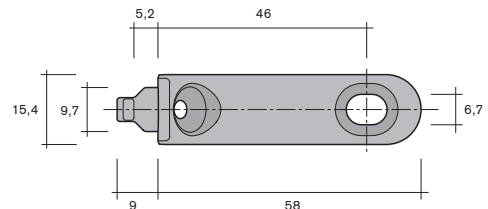
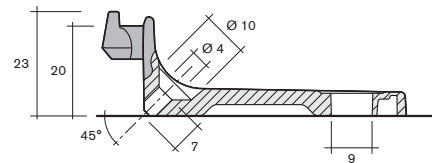

**99.6590**

**1.500**

**mit Gewindedubel M4, seitlich schraubbar**  
passend fur Euro-Schraube und Senkkopfschraube  
**with thread anchor M4, screwable at side**  
suitable for Euro screw and countersunk screw

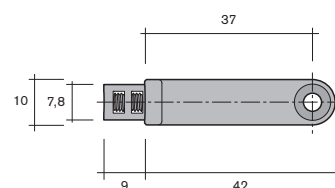
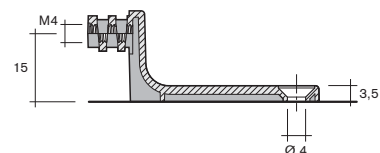

# Schrankrohlager

## wardrobe tube supports

Art.-Nr.      Verp. Einheit      Ausfuhrung      Farben: wei, braun, beige  
 art.-no.      packing units      type      colours: white, brown, beige

57.0860	5.500	<b>fur Stangen <math>\varnothing</math> 19 mm</b> Dubel X = $\varnothing$ 6 mm, 1 Schraubloch $\varnothing$ 3,6 mm <b>for <math>\varnothing</math> 19 mm tubes</b> dowel X = $\varnothing$ 6 mm, 1 screw hole $\varnothing$ 3.6 mm
57.0810	500	<b>fur Stangen <math>\varnothing</math> 19 mm</b> Dubel X = $\varnothing$ 5 mm, 1 Schraubloch $\varnothing$ 3,6 mm <b>for <math>\varnothing</math> 19 mm tubes</b> dowel X = $\varnothing$ 5 mm, 1 screw hole $\varnothing$ 3.6 mm
57.0820	500	<b>fur Stangen <math>\varnothing</math> 19 mm</b> Dubel X = $\varnothing$ 5 mm <b>for <math>\varnothing</math> 19 mm tubes</b> dowel X = $\varnothing$ 5 mm
57.0840	500	<b>fur Stangen <math>\varnothing</math> 19 mm</b> 2 Schraublocher $\varnothing$ 3,6 mm x 10,5 Tlg. <b>for <math>\varnothing</math> 19 mm tubes</b> 2 screw holes $\varnothing$ 3.6 mm x 10.5 Tlg.

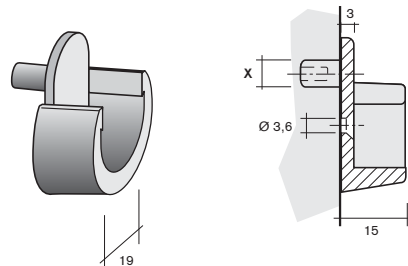

57.0850	3.000	<b>fur Stangen <math>\varnothing</math> 25 mm</b> Dubel $\varnothing$ 5 mm, 1 Schraubloch $\varnothing$ 3,4 mm <b>for <math>\varnothing</math> 25 mm tubes</b> dowel $\varnothing$ 5 mm, 1 screw hole $\varnothing$ 3,4 mm
57.0910	3.000	<b>fur Stangen <math>\varnothing</math> 25 mm</b> 1 Schraubloch $\varnothing$ 3,4 mm, ohne Zapfen <b>for <math>\varnothing</math> 25 mm tubes</b> 1 screw hole $\varnothing$ 3,4 mm, without pin

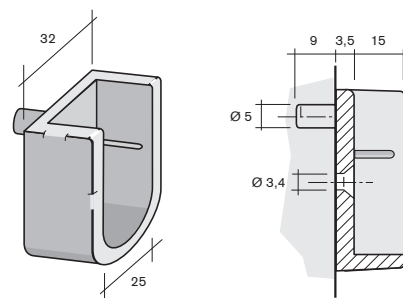

57.1020	2.000	<b>fur Stangen <math>\varnothing</math> 15 mm</b> zweifach geschraubt, Schraubloch $\varnothing$ 3,2 mm Teilung 32 mm <b>for <math>\varnothing</math> 15 mm tubes</b> screwed on twice, screw hole $\varnothing$ 3.2 mm spacing 32 mm
57.1110	1.800	<b>fur Stangen <math>\varnothing</math> 15 mm</b> zweifach geschraubt, Schraubloch $\varnothing$ 3,2 mm Teilung 32 mm <b>for <math>\varnothing</math> 15 mm tubes</b> screwed on twice, screw hole $\varnothing$ 3.2 mm spacing 32 mm

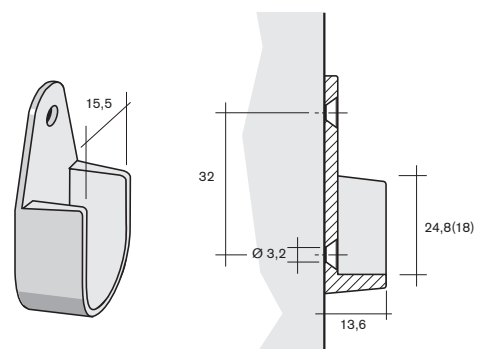

Ma 24,8 = **57.1110**

Ma 18,0 = **57.1020**

# Schrankrohlager

## wardrobe tube supports

 **Henke Beschlage**

Art.-Nr.      Verp. Einheit      Ausfuhrung      Farben: wei, braun, beige  
 art.-no.      packing units      type      colours: white, brown, beige

**57.0830**

**500**

**fur Stangen  $\varnothing$  27 mm**  
 Dubel  $\varnothing$  6 mm, 1 Schraubloch  $\varnothing$  3 mm  
**for  $\varnothing$  27 mm tubes**  
 dowel  $\varnothing$  6 mm, 1 screw hole  $\varnothing$  3 mm

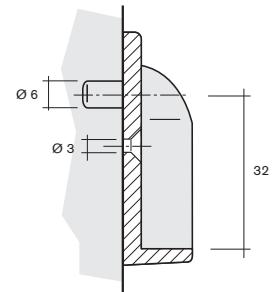
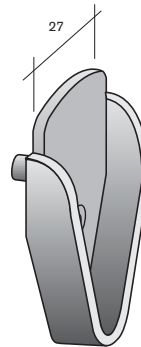

**57.1150**

**1.500**

**fur Stangen  $\varnothing$  27 mm**  
 3 Schraublocher  $\varnothing$  3 mm  
**for  $\varnothing$  27 mm tubes**  
 3 screw holes  $\varnothing$  3 mm

**57.0790**

**4.000**

**fur Stangen  $\varnothing$  15 mm**  
 2 Dubel  $\varnothing$  5 x 32 mm, 1 Schraubloch  $\varnothing$  3,5 mm  
**for  $\varnothing$  15 mm tubes**  
 2 dowels  $\varnothing$  5 x 32 mm, 1 screw hole  $\varnothing$  3.5 mm

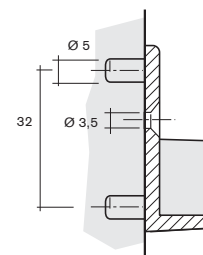
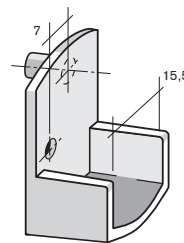

**57.1050**

**4.000**

**fur Stangen  $\varnothing$  15 mm**  
 1 Dubel  $\varnothing$  10 mm, 1 Schraubloch  $\varnothing$  3,5 mm  
**for  $\varnothing$  15 mm tubes**  
 1 dowel  $\varnothing$  10 mm, 1 screw hole  $\varnothing$  3.5 mm

**57.0870**

**1.700**

**fur 15 mm Rohr**  
 2 Dubel  $\varnothing$  6 x 64 mm, 1 Schraubloch  $\varnothing$  4,3 mm  
**for 15 mm tube**  
 2 dowels  $\varnothing$  6 x 64 mm, 1 screw hole  $\varnothing$  4.3 mm

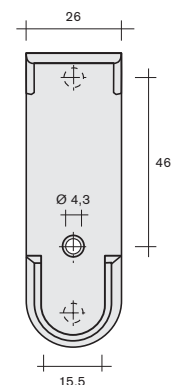
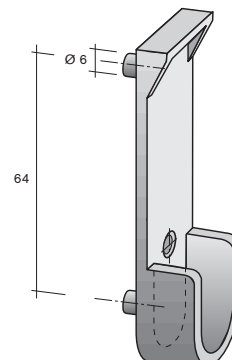



# Schrankrohlager

## wardrobe tube supports

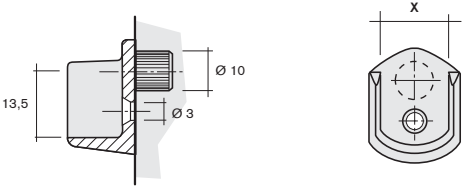
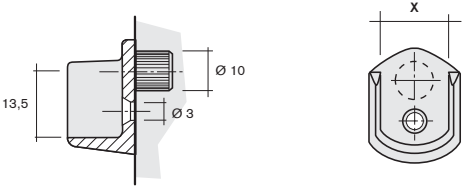
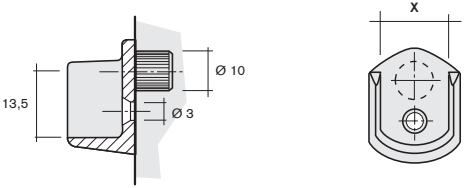
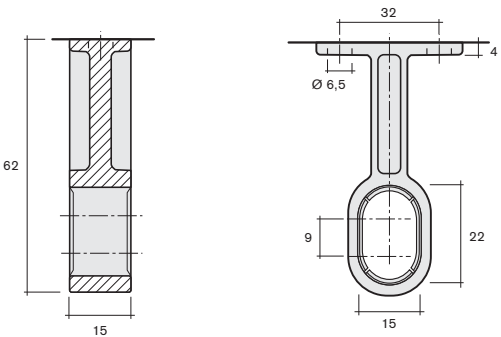
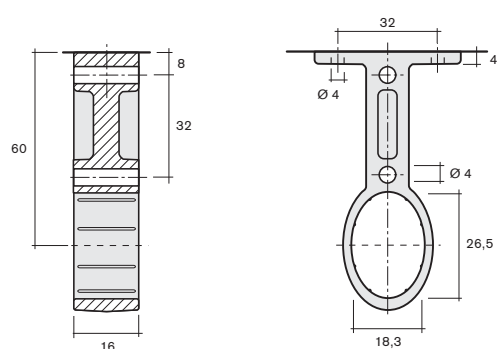
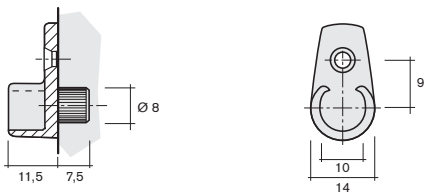
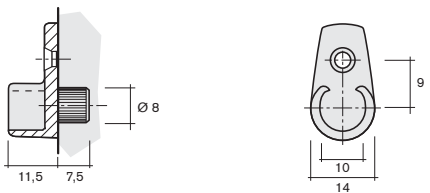
Art.-Nr. art.-no.	Verp. Einheit packing units	Ausfuhrung type	Farben: wei, braun, beige colours: white, brown, beige
57.0760	5.000	<b>fur X = 15 mm Rohr</b> Dubel $\varnothing$ 10 mm, 1 Schraubloch <b>for X = 15 mm tube</b> dowel $\varnothing$ 10 mm, 1 screw hole	
57.0880	5.000	<b>fur X = 15,2 mm Ovalrohr</b> Dubel $\varnothing$ 10 mm, 1 Schraubloch <b>for X = 15.2 mm oval-tube</b> dowel $\varnothing$ 10 mm, 1 screw hole	
57.0770	5.000	<b>fur X = 17 mm Rohr</b> Dubel $\varnothing$ 10 mm, 1 Schraubloch <b>for X = 17 mm tube</b> dowel $\varnothing$ 10 mm, 1 screw hole	
57.0890	1.500	<b>zum Anschrauben unter dem Fachboden</b> fur Rohr 15 x 22 mm 2 Schraublocher $\varnothing$ 6,5 mm <b>for screwing under the shelf</b> for tube 15 x 22 mm 2 screw holes $\varnothing$ 6.5 mm	
57.1010	1.400	<b>fur Ovalrohr 26 x 18 mm</b> 2 + 2 Schraublocher $\varnothing$ 4 mm, Teilung 32 mm <b>for oval-tube 26 x 18 mm</b> 2 + 2 screw-holes $\varnothing$ 4 mm, spacing 32 mm	
57.0900	7.500	<b>fur 10 mm Rohr</b> Dubel $\varnothing$ 8 mm, 1 Nagelloch <b>for tube 10 mm</b> dowel $\varnothing$ 8 mm, 1 nail hole	
57.1030	7.500	<b>fur 10 mm Rohr</b> schraubbar ohne Dubel <b>for tube 10 mm</b> screwable without dowel	

# Metall-Schrankrohrlager Ausführung: vernickelt

metal wardrobe tube supports

finish: nickel-plated

 **Henke Beschlage**

Art.-Nr.      Verp. Einheit      Ausfuhrung  
art.-no.      packing units      type

**99.0010**

**600**

**fur 15 mm Rohr**  
2 Dubel  $\varnothing$  5 mm, Teilung 32 mm  
**for 15 mm tube**  
2 dowels  $\varnothing$  5 mm, spacing 32 mm

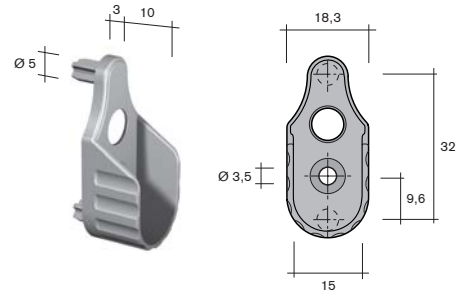

**99.0020**

**700**

**fur 15 mm Rohr**  
3 Schraublocher  $\varnothing$  3,7 mm  
**for 15 mm tube**  
3 screw holes  $\varnothing$  3.7 mm

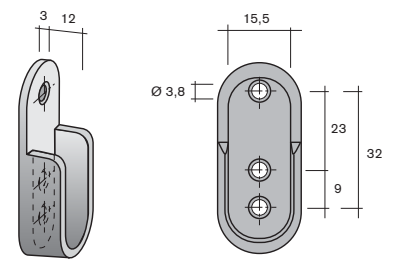

**99.0070**

**650**

**fur 15 mm Stangen**  
1 Dubel  $\varnothing$  10 mm, 1 Schraubloch  $\varnothing$  3,8 mm  
**for 15 mm tubes**  
1 dowel  $\varnothing$  10 mm, 1 screw hole  $\varnothing$  3.8 mm

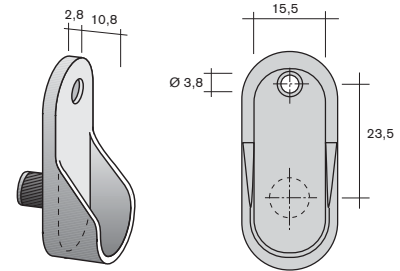

**99.6420**

**500**

**fur 15 mm Stangen**  
2 Schraublocher  $\varnothing$  4,2 mm  
mit Gewinde M6  
**for 15 mm tube**  
2 screw holes  $\varnothing$  4.2 mm  
with screw thread M6

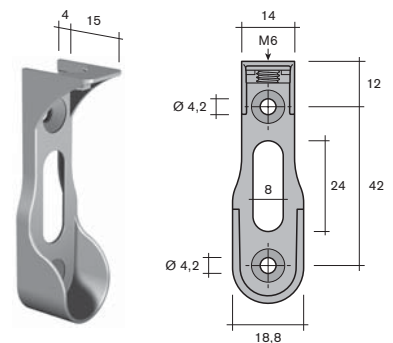

**99.5050**

**350**

**fur 15 mm Stangen**  
2 Dubel  $\varnothing$  5,9 x 64 mm,  
2 Schraublocher  $\varnothing$  4,7 x 32 mm  
**for 15 mm tubes**  
2 dowels  $\varnothing$  5.9 x 64 mm,  
2 screw holes  $\varnothing$  4.7 x 32 mm

